

# unboxing to transforming design competition entry

**HINGE**  
architecture  
interiors  
furniture  
505b neelkanth  
99, marine drive  
mumbai 400020

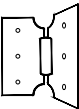

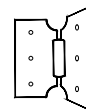

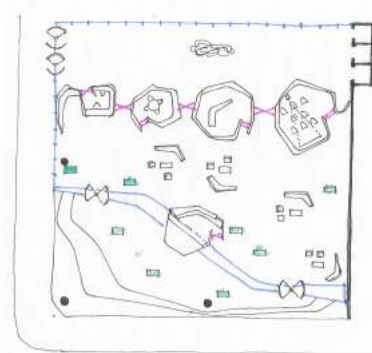
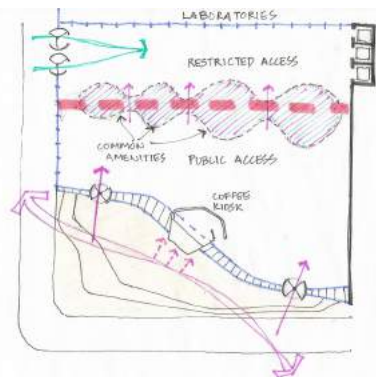
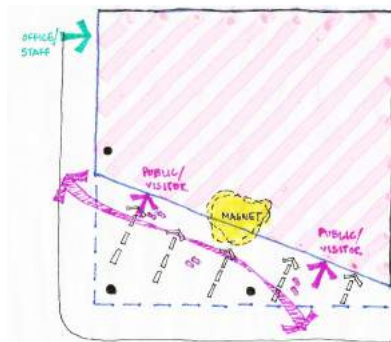
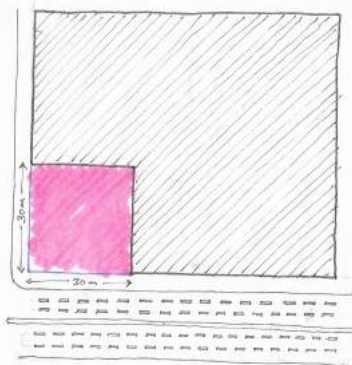
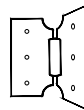
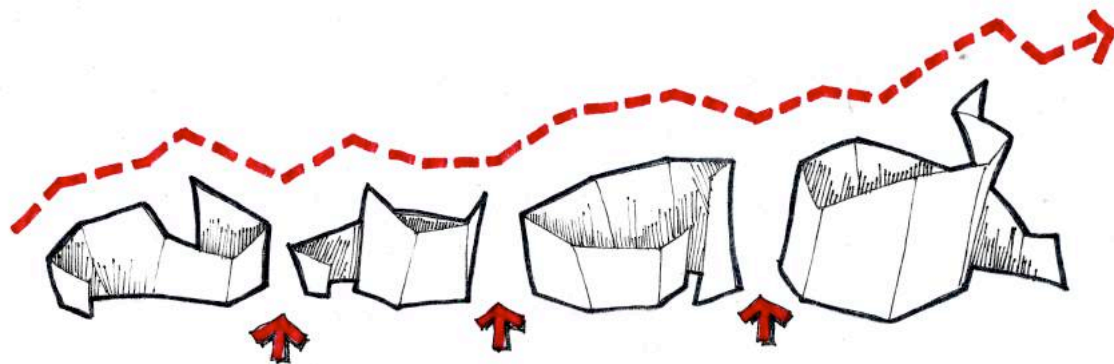

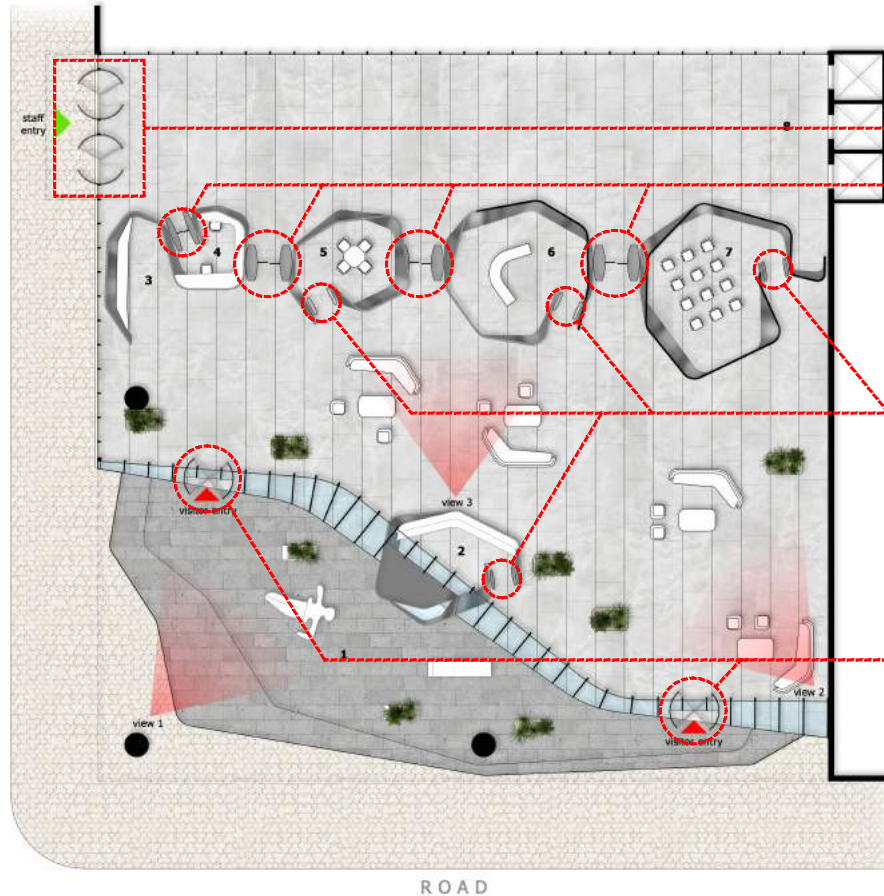

#### Legend

1. open plaza
2. coffee kiosk
3. waiting area
4. reception
5. meeting pod
6. exhibition pod
7. audio-visual pod
8. elevators

#### Tourlock 180

The Tourlock is a revolving door the rotation of which can only be started after an authorisation signal from an access control system such as a card reader or biometrics reader. It can be integrated with a variety of different security systems that accurately detect any form of piggybacking or tailgating. We have used the Tourlock 180+ 90 - an automated four wing version - to provide controlled access for staff into the building.



#### Speedlane slide

The Speedlane Slide interacts with those who approach it, managing and guiding authorised users through to the secured areas of buildings. We have used the maximum gate width of 910mm to allow for wheelchair access, which gives visitors holding the correct pass entry into the elevator concourse. Dedicated staff entry into the reception and coffee kiosk pods is also achieved using these.



#### Speedlane open

The Speedlane Open assists with channelling the flow of people entering and moving around buildings, without a physical barrier. Commonly operating in multiples, it acts as a boundary between public and private worlds, guiding users to their destination under the watchful eyes of a security guard. It interacts with both worlds to ensure the right people are channelled to the right place, alerting security guards if there is a breach of access. We have used these at the entry to the meeting, exhibition and AV pods.



#### Crystal tourniket

Constructed virtually completely from glass with only a few stainless steel accents to ensure the solidity of the revolving door, it fits seamlessly and minimally with our inclined glass facades onto the plaza.

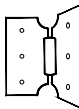





perspective view 1





perspective view 2  
iGen design competition entry | june 2017





perspective view 3